

uno618

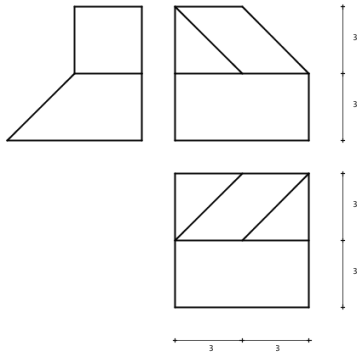

Ángulo XY =  $135^\circ$   
Coeficiente Y = 0.75

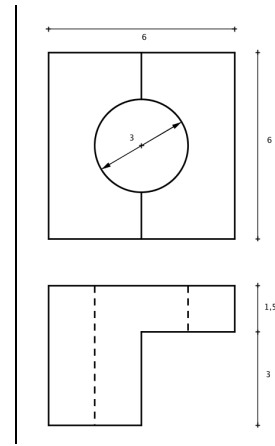

Ángulo XY =  $135^\circ$   
Coeficiente Y = 0.8

Perspectiva Caballera.

uno618

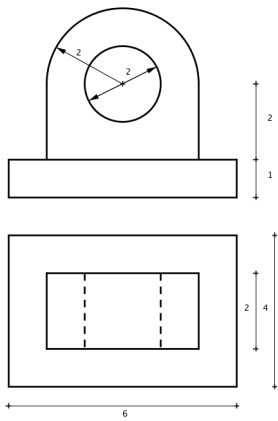

Ángulo XY = 45°  
Coeficiente Y = 0.6

Perspectiva Caballera.

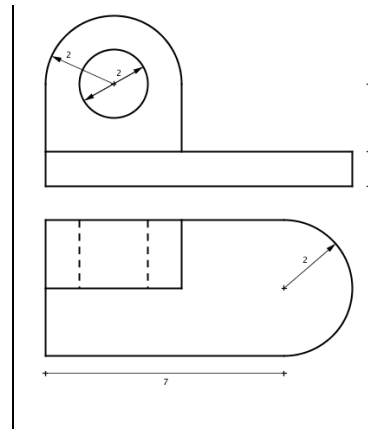

Ángulo XY = 45°  
Coeficiente Y = 0.75